

## SoundTouch™ Controller



# CONTENTS

Warranty .....	2
Product Description .....	3
Carton Contents .....	3
Packaging Parts List .....	4
Figure 1. Packaging View .....	4
Performance Verification Tests .....	5
Service Manual Revision History .....	6

**CAUTION: The Bose® SoundTouch™ Controller contains no user-serviceable parts. To prevent warranty infractions, refer servicing to warranty service stations or factory service.**

PROPRIETARY INFORMATION  
THIS DOCUMENT CONTAINS PROPRIETARY INFORMATION OF BOSE CORPORATION WHICH IS BEING FURNISHED ONLY FOR THE PURPOSE OF SERVICING THE IDENTIFIED BOSE PRODUCT BY AN AUTHORIZED SERVICE CENTER OR OWNER OF THE BOSE PRODUCT, AND SHALL NOT BE REPRODUCED OR USED FOR ANY OTHER PURPOSE.

## WARRANTY

The Bose SoundTouch Controller is covered by a 1-year limited warranty. Warranty in Europe is 2 years.

# PRODUCT DESCRIPTION

The Bose® SoundTouch™ controller is used to control Bose SoundTouch systems. It is included in the carton with the SoundTouch Stereo JC WI-FI music system and the SoundTouch SA-4 amplifier. It is also available as an accessory for other Bose SoundTouch products.

The SoundTouch controller is paired to a product using the SoundTouch application. This application is a free download from the [bose.com](http://bose.com) web site, and is available for PC, Mac, Android and iOS products. Once you have the app installed and open, click on Explore / Settings, and then Systems. Select the system you wish to connect the SoundTouch controller to and then click CONNECT SOUNDTOUCH CONTROLLER.

The SoundTouch controller is a Bluetooth Low Energy (BTLE) based 2.4GHz remote control that communicates with the Wi-Fi module integrated into the SoundTouch systems. The remote contains two PCBs, one referred to as the Main PCB, which contains the main processor and radio functionality. There is a secondary board, referred to as the Capsense PCB, which has the capacitive sensors and LEDs for the Favorites/Presets wheel. The remote also contains the following features/functions:

- An outer rotating ring that controls the volume of the client system.
- A 128 x 100 pixel organic light emitting diode (OLED) display for presenting presets/favorites as well as volume and any system error or status messages to the user.
- A capacitive wheel to allow the user to scroll through their presets/favorites.
- Two capacitive buttons for transport controls.
- A snap dome switch for on/off and preset/favorite selection.
- A proximity sensor to wake the remote up as a user approaches it.
- A TAP access port to support manufacturing software updates and TAP control of the remote.
- Power provided by 4 AA batteries.



The SoundTouch Controller is not considered to be repairable. Repair parts are not inventoried, with the exception of the battery door.

## Carton Contents

- SoundTouch Controller
- Four AA batteries
- Hardware Kit - contains 2 Philips-head wood screws and 2 plastic wall anchors
- Wall mount plate
- Quickstart guide

# PACKAGING PARTS LIST

Item Number	Material Number	Description	Package Variant
1	-	SUB ASSY, SOUNDTOUCH™ CONTROLLER	SYSTEM, ACCESSORY
2	715472-001S	BATTERY DOOR	SYSTEM, ACCESSORY
3	263269-001	BATTERY, AA SIZE, SINGLE	SYSTEM, ACCESSORY
4	373903-0010	KIT, HARDWARE, WALL MOUNT	SYSTEM, ACCESSORY
5	363677-0010	PACKING, TRAY, LS	SYSTEM, ACCESSORY
6	374365-0010	ASSEMBLY, WALL BRACKET	SYSTEM, ACCESSORY
7	363678-0010	PACKING, TRAY, BTM	SYSTEM, ACCESSORY
8	370752-0010	QSG, ST CONTROLLER, AST	AST, ACCESSORY
	627128-0010	GUIDE, QUICKSTART, ST CONTROLLER, 1 OF 3, EU	EU, ACCESSORY
	627129-0010	GUIDE, QUICKSTART, ST CONTROLLER, 2 OF 3, EU	EU, ACCESSORY
	627130-0010	GUIDE, QUICKSTART, ST CONTROLLER, 3 OF 3, EU	EU, ACCESSORY
	627131-0010	GUIDE, QUICKSTART, ST CONTROLLER, 1 OF 2, AP	AP, ACCESSORY
	627132-0010	GUIDE, QUICKSTART, ST CONTROLLER, 2 OF 2, AP	AP, ACCESSORY
9	363676-0010	PACKING, TRAY, TOP	SYSTEM, ACCESSORY
10	363673-0010	CARTON, DC, F, 5.94X5.94X2.56	SYSTEM, ACCESSORY
11	363674-0010	PACKING, SLEEVE	ACCESSORY
12	627671-0010	BAG, SHRINK, 15X12IN, 100GA, PRE-PERFORATED	ACCESSORY
13	363680-0010	CARTON, RSC, 200B, 12.75 X6.38 X 5.75	4 OVERPACK, ACCESSORY
14	308931-001	CARTON, HSC, 22.63X14.00X11.50	22 OVERPACK, SYSTEM

**Note:** The SoundTouch controller is packaged as an accessory or bundled with a system.

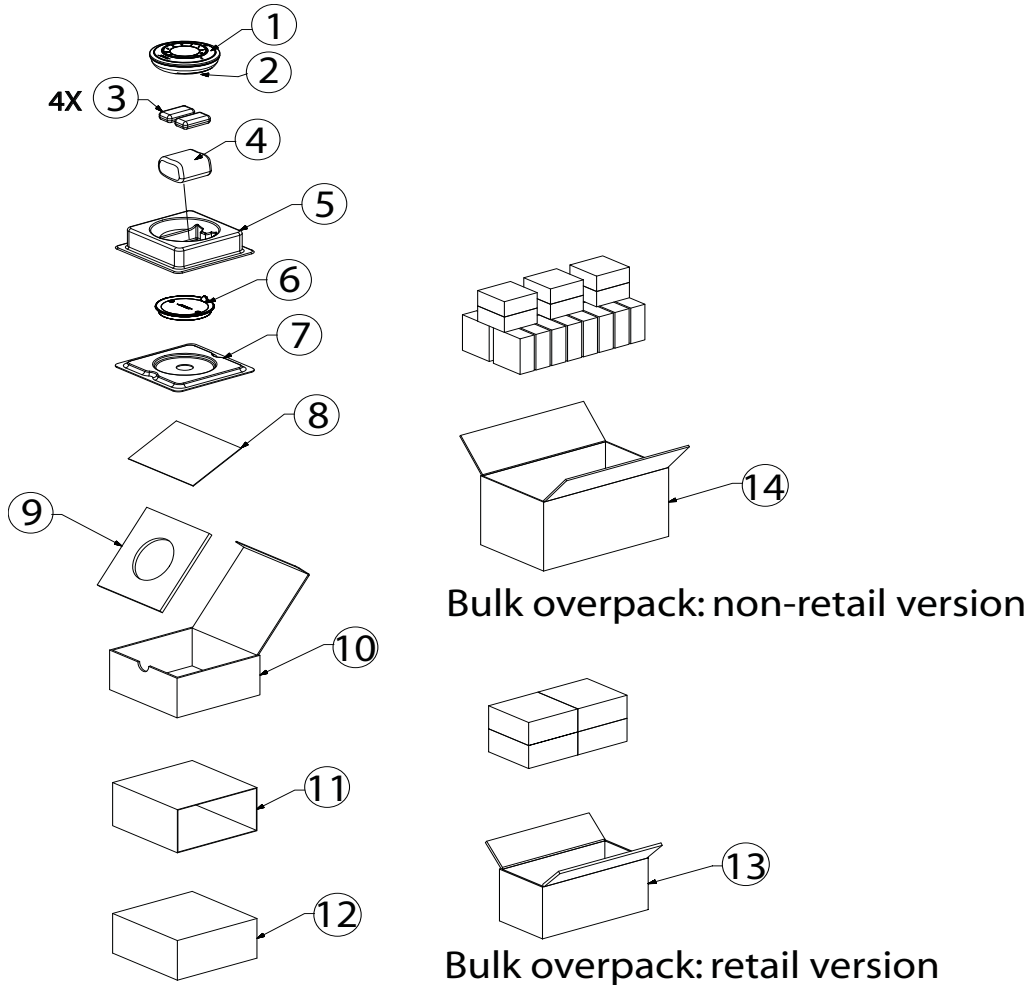

**Figure 1. Packaging View**

# PERFORMANCE VERIFICATION TESTS

Download the Bose® SoundTouch™ PC application at [http://www.Bose.com/soundtouch\\_app](http://www.Bose.com/soundtouch_app)

## 1. Connect the SoundTouch Controller to a SoundTouch system

**Note:** The SoundTouch product or system must be connected to your Wi-Fi network to be able to connect to the SoundTouch Controller.

1.1 Open the SoundTouch app and click on EXPLORE.

1.2 Click on SETTINGS.

1.3 Click on SYSTEMS.

1.4 Click on the system you want to connect the SoundTouch controller to.

1.5 Click on CONNECT SOUNDTOUCH CONTROLLER.

1.6 Install the batteries in the SoundTouch Controller.

**Note:** Once connected to a SoundTouch system, If a software update is available, the SoundTouch controller will update.

## 2. Functional Test

**2.1 Volume:** Rotate the outer volume ring ensuring the volume changes and the OLED indicates the changes in volume level. The ring should rotate smoothly.

**2.2 Preset:** Press the each of the 6 numbered presets located on the inner circle ensuring the unit and remote responds properly.

**2.3 Skip:** While playing a song from a music library, touch the skip forward and skip backward buttons, ensuring the unit and remote's OLED responds properly

**2.4 Pause:** Press down on the center of the remote display until it clicks. Ensure a playing song has paused. Press down on the center of the display again to resume play.

**2.5 Proximity Sensor:** Allow the remote to go into stand by. Once the display is blank, hold your hand a few inches over the remote to activate it. Ensure the remote turns on without touching it.

**2.6 Disconnect Remote:** Touch the SoundTouch Icon. The remote will count down from 5 to 1 and then indicate it is ready for a new connection.

**2.7 Set the controller to factory default state.** Remove one battery with the other three installed. Hold down the main display button and re-insert the fourth battery. You will see a circular arrow, indicating that the unit is resetting. Release the main display button. Once released you will see the "open book" icon with an "i" in it to indicate that the controller is now in the factory default state. See above.

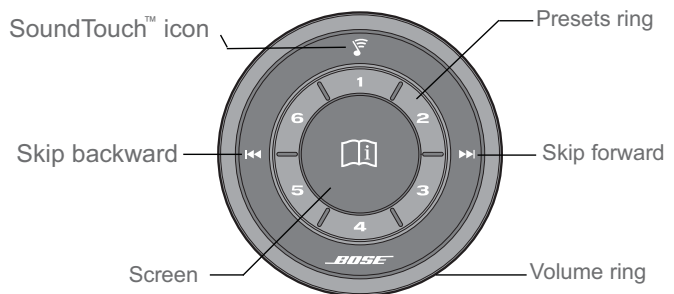

## Service Manual Revision History

<b>Date</b>	<b>Revision Level</b>	<b>Description of Change</b>	<b>Change Driven By</b>	<b>Pages Affected</b>
4/14	00	Document released at revision 00.	Service manual release	All
8/14	01	Added factory default step to test procedures.	Test procedure change	5

Specifications and Features Subject to Change Without Notice

---

***BOSE***<sup>®</sup>  
***Better sound through research***<sup>®</sup>

Bose Corporation  
The Mountain  
Framingham Massachusetts USA 01701

P/N: 628456-SM Rev. 01 8/14 (H)  
<http://serviceops.bose.com>